

Date: May, 6th, 2015

Bulletin: SB15050025

Subject: New Crankshaft Pulley- Jumpy-Expert-Scudo 1.6

This bulletin is issued to clarify the impact of the crankshaft pulley change on PSA G9 engine on existing and new compressor drive kits.

Original Crankshaft pulley until Jan 2015:

Early this year, PSA replaced the original cast iron crankshaft pulley by a steel one. The original cast iron pulley has the PSA reference: **185 A 240C 9654961080**

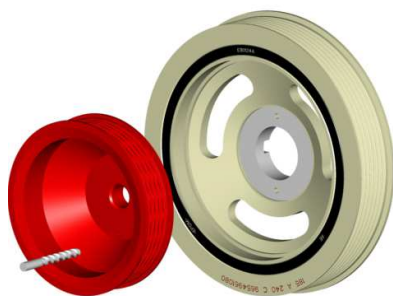

The new steel pulley has the PSA reference: **A 12 9810714580**



It is not possible to install an additional drive pulley on the new steel crankshaft pulley.

To install the Mount and Drive Kits **KC12050270E** and **KC 12060276E**, it is necessary to remove the steel pulley reference A129810714580 and install the reference: 185 A 240C 9654961080.

The cast iron part is available in the aftersales organization of PSA.